

Guss-Kältemittelfilter - Cast Iron Refrigerant Strainers

Filter mit Flanschanschluß
 Strainers with flange connection

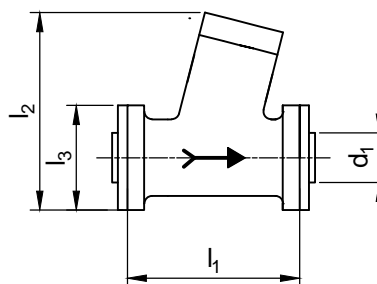

Schweißanschluß - Welding connection	Order Number	FAS-Typ	d_1 DN	l_1	l_2	l_3
	822 106 000	FF15	15	60	90	80/45
	822 100 000	FF20	20	90	138	100/56
	822 111 000	FF25	25	90	138	100/56
	822 113 000	FF32	32	132	194	□ 80
	822 114 000	FF40	40	132	194	□ 80
	822 115 000	FF50	50	188	261	□ 100

Lötanschluß - Soldering connection	Order Number	FAS-Typ	d_1 für Rohr-A-Ø	l_1	l_2	l_3
	823 104 000	FF12	12	60	90	80/45
	823 106 000	FF15	15	60	90	80/45
	823 107 000	FF16	16	60	90	80/45
	823 110 000	FF22	22	90	138	100/56
	823 111 000	FF28	28	90	138	100/56
	823 113 000	FF35	35	132	194	□ 80
	823 114 000	FF42	42	132	194	□ 80
	823 115 000	FF54	54	188	261	□ 100

Filtereinsätze Filter Inserts

Order Number	FAS-Typ	für Filter-Typ
821 201 100	SFLA102	SF + SFL + SFLA 6, 8, 10
821 204 100	SFLA103	SF + SFL + SFLA 12
821 206 100	SFLA104	SF + SFL + SFLA 15, 16, 18
821 200 100	SFLA105	SF + SFL + SFLA 22
822 106 100	FF115	FF15
822 111 100	FF125	FF25
822 114 100	FF140	FF40
822 115 100	FF150	FF50
822 116 100	FF165	FF65