

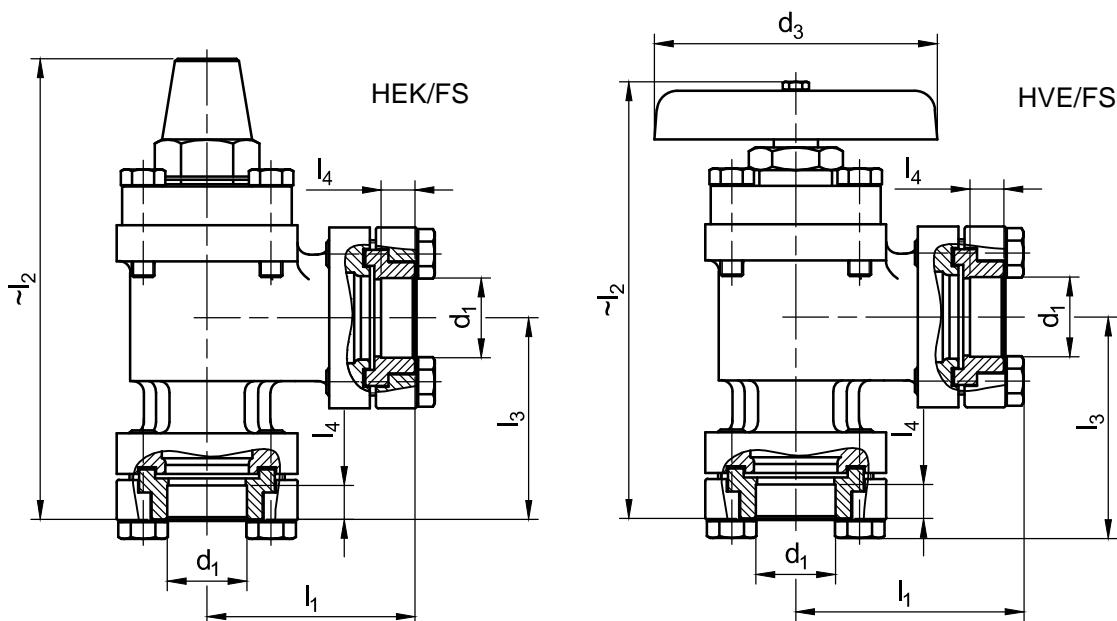

Gußabsperrventil (Eck) mit Lötflanschanschluss Cast Iron Shutoff Valve (angle) with solder flange connection



Order Number	FAS-Typ	d ₁	d ₄	l ₁	~l ₂	l ₃	l ₄	Kv m ³ /h
805 304 000	HEK15/12 FS	12	-	53	117	53	12	3,3
805 306 000	HEK15/15 FS	15	-	53	117	53	12	3,9
805 307 000	HEK15/16 FS	16	-	53	117	53	12	3,9
805 308 000	HEK25/18 FS	18	-	79	160	72	15	11,7
805 300 000	HEK25/22 FS	22	-	79	160	72	15	11,7
805 311 000	HEK28 FS	28	-	79	160	72	15	11,7
805 313 000	HEK35 FS	35	-	92	209	90	15	41,0
805 314 000	HEK42 FS	42	-	92	209	90	15	41,0
805 315 000	HEK54 FS	54	-	109	237	106	15	53,0
805 316 000	HEK64/64 FS	64	-	120	260	115	15	74,0
805 318 000	HEK64/70 FS	70	-	120	260	115	15	74,0
805 319 000	HEK80/76 FS	76	-	133	332	143	15	111,0
805 320 000	HEK80/80 FS	80	-	133	332	143	15	111,0
805 404 000	HVE15/12 FS	12	59	53	117	53	12	3,3
805 406 000	HVE15/15 FS	15	59	53	117	53	12	3,9
805 407 000	HVE15/16 FS	16	59	53	117	53	12	3,9
805 408 000	HVE25/18 FS	18	85	79	160	72	15	11,7
805 400 000	HVE25/22 FS	22	85	79	160	72	15	11,7
805 411 000	HVE28 FS	28	85	79	160	72	15	11,7
805 413 000	HVE35 FS	35	140	92	209	90	15	41,0
805 414 000	HVE42 FS	42	140	92	209	90	15	41,0
805 415 000	HVE54 FS	54	140	109	237	106	15	53,0
805 416 000	HVE64/64 FS	64	180	120	260	115	15	74,0
805 418 000	HVE64/70 FS	70	180	120	260	115	15	74,0
805 419 000	HVE80/76 FS	76	200	133	332	143	15	111,0
805 420 000	HVE80/80 FS	80	200	133	332	143	15	111,0

Dichtungssatz erhältlich
 gasket set available

Reparatursatz erhältlich
 repair set available

Kv-Wert (Wasserdurchfluss bei einer Druckdifferenz von 1 bar)
 Kv-value (water flow with a difference of pressure of 1 bar)